

We propose an architectural intervention that engages the site with humility and restraint, integrating into the existing spatial order. It aims to amplify the dramatic atmosphere imbued by the wooden cabin, trees, and mist—evoking a sense of coexistence between humans and the spirits of folklore on this land.

**Mass & Syntax**

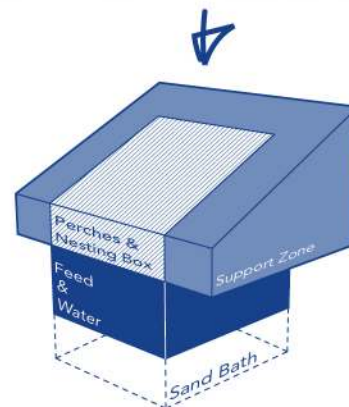

**Instinct & Structure**

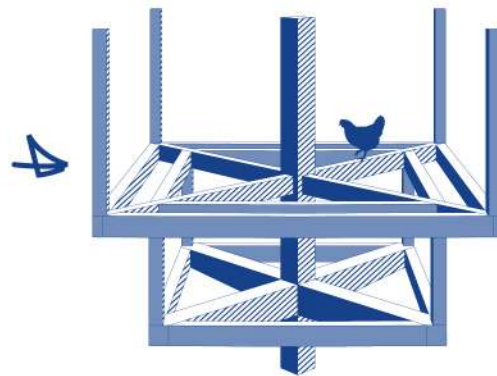



# Ten-feather Cottage

Architecture ceases to be a mere container for chickens. Instead, it becomes a physical manifestation of their innate behaviors—the chickens do not merely “use” the building, but “inhabit an amplified version of their own instincts.” The interior space is fully optimized for the comfort of ten hens. Key features, including perches with an effective length exceeding 3.5 meters (Deducted perches that are spaced too closely or have insufficient clearance above.) and two utility storage cabinets that can be converted into additional nesting boxes, enable potential expansion of the flock to its maximum capacity.

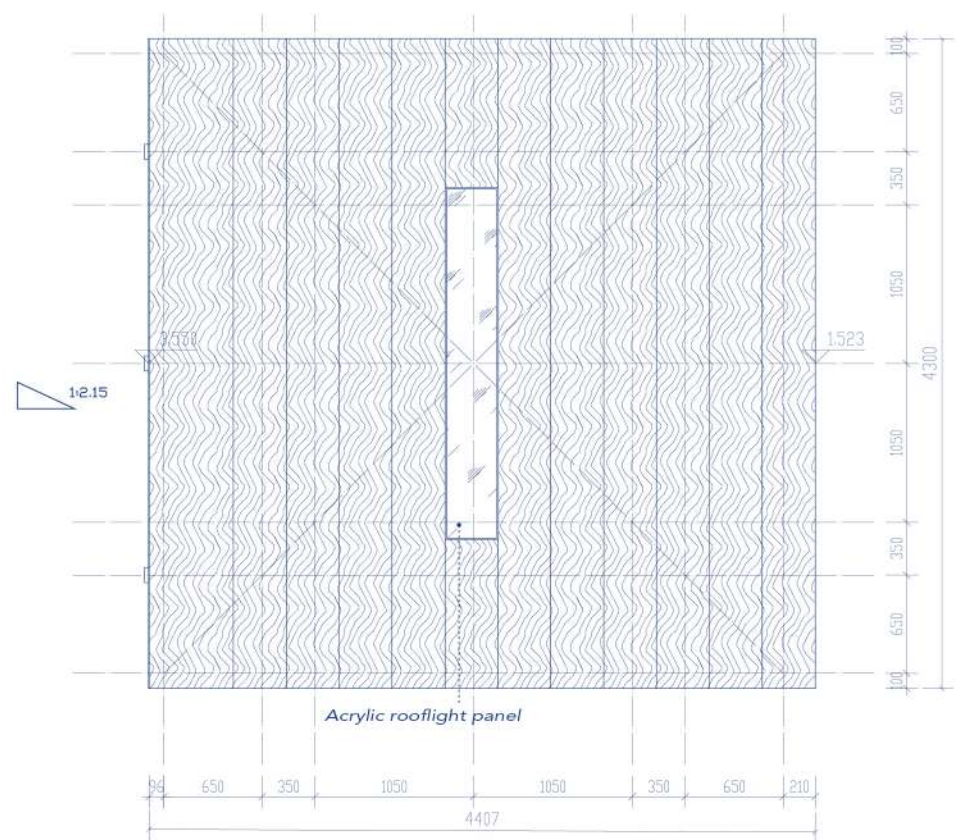
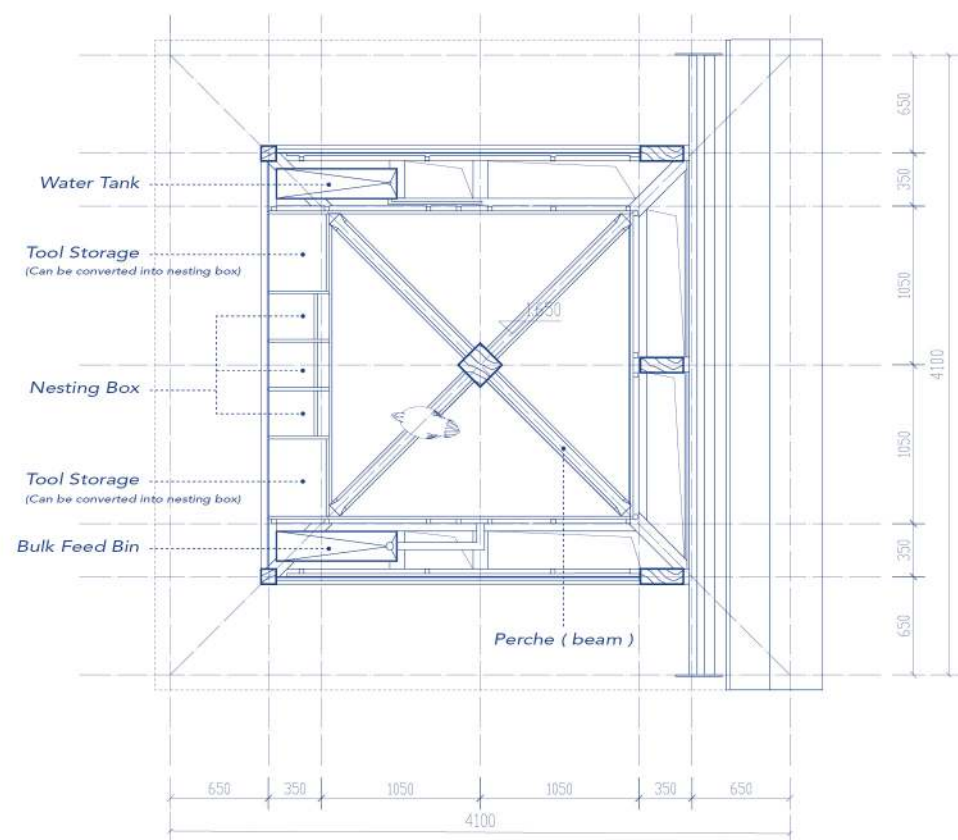
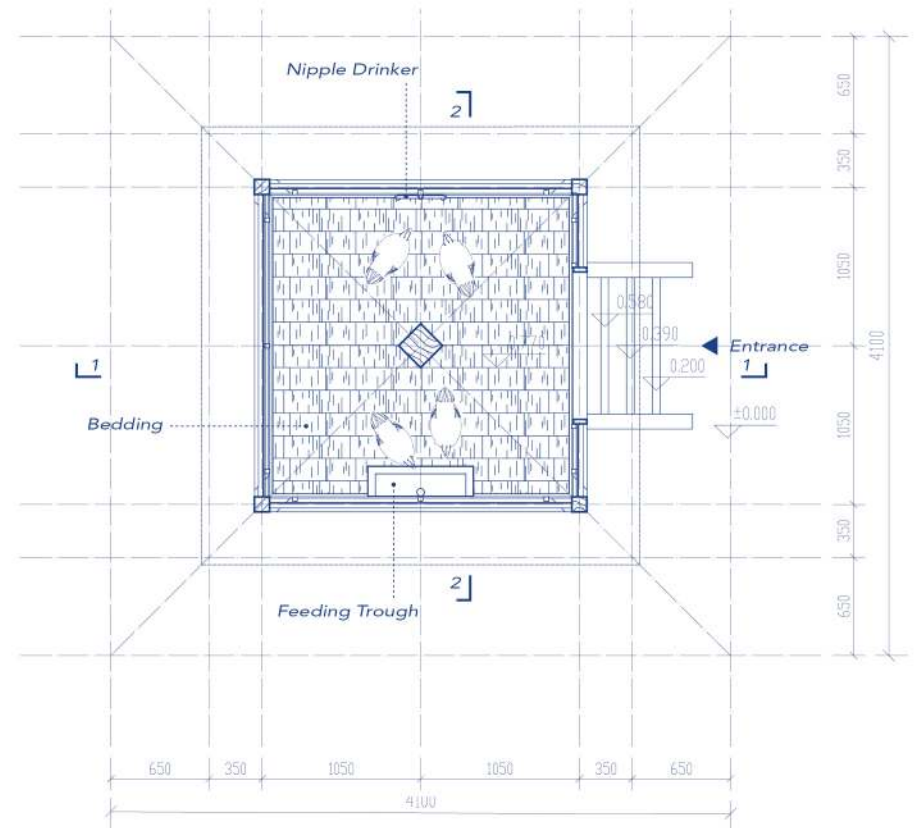
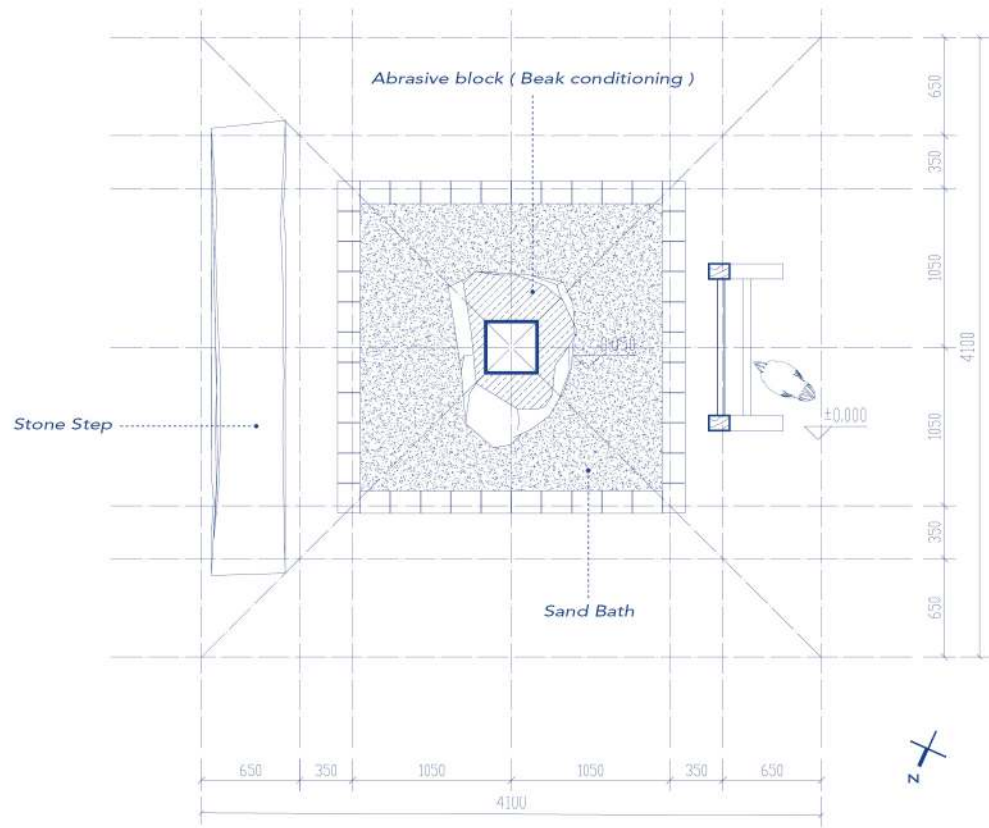

# Ten-feather Cottage

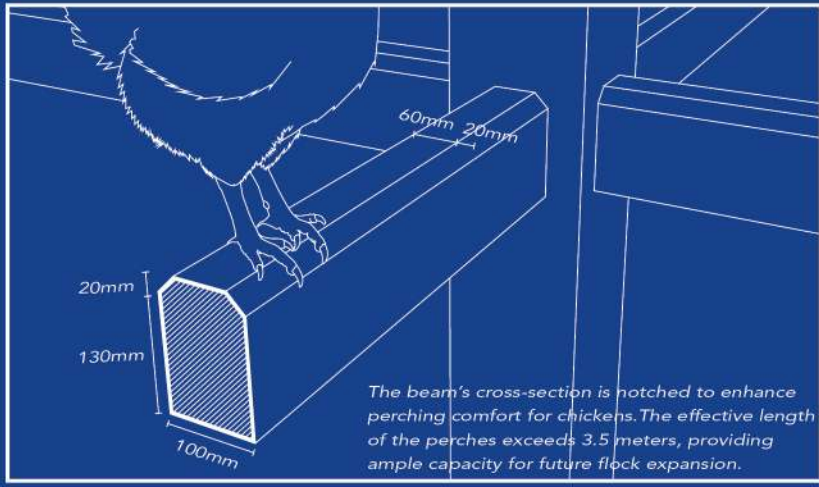

Perche ( beam )

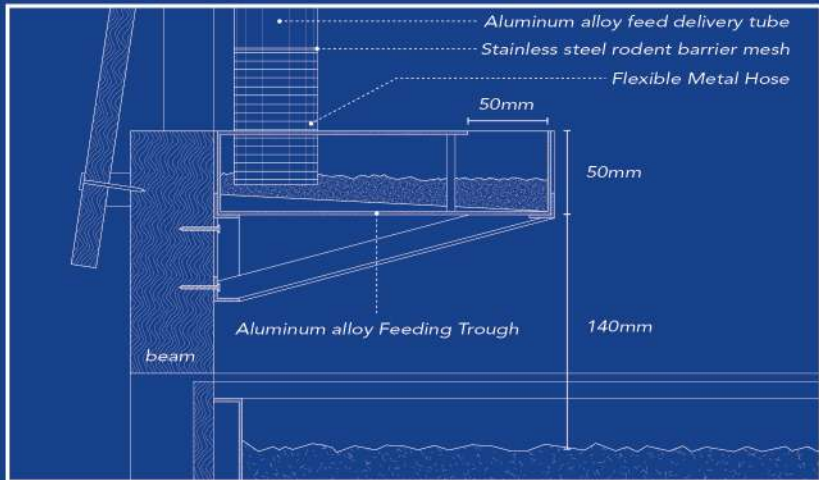

Feeding Trough

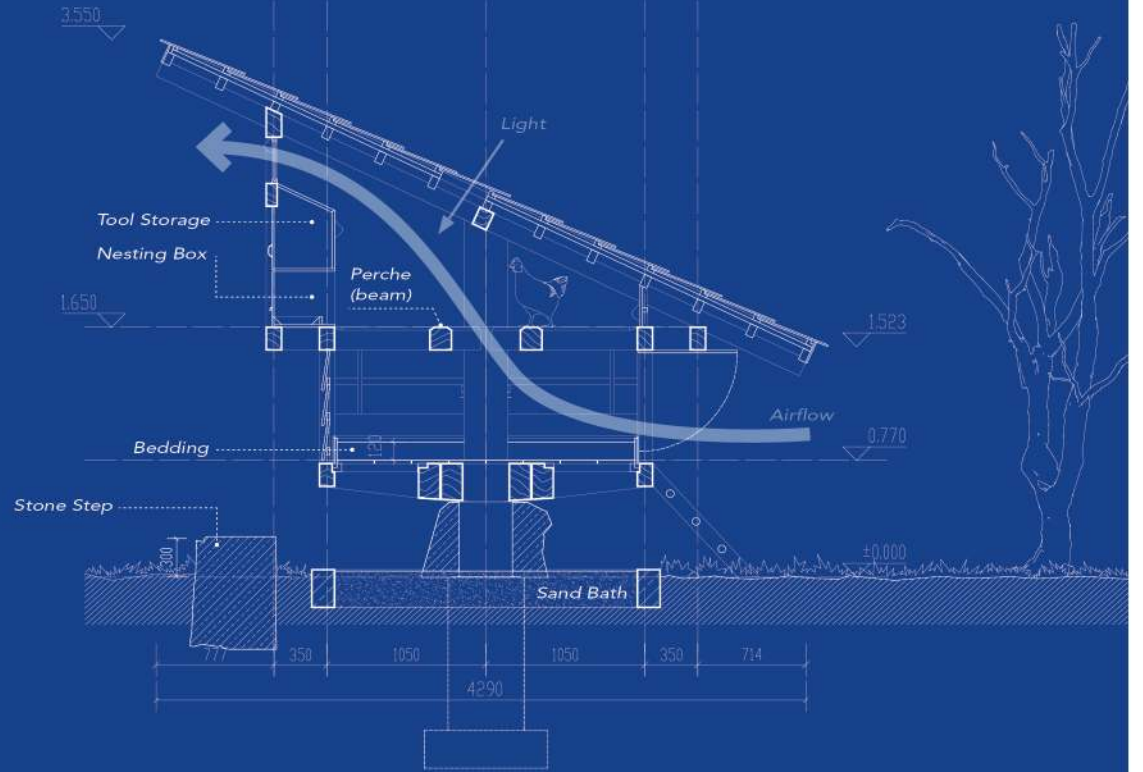

Section 1-1 1:50

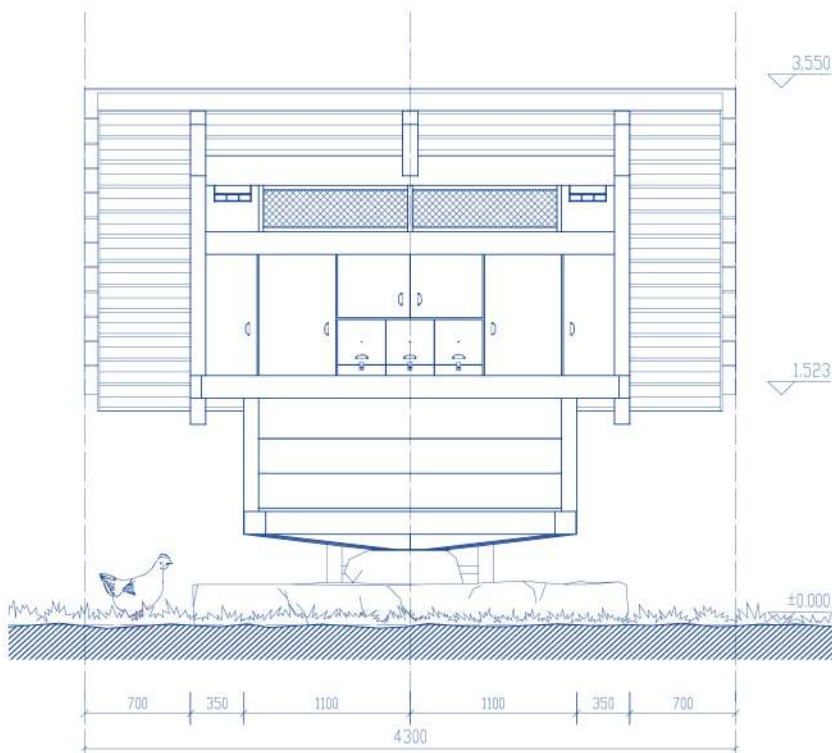

East Elevation 1:50

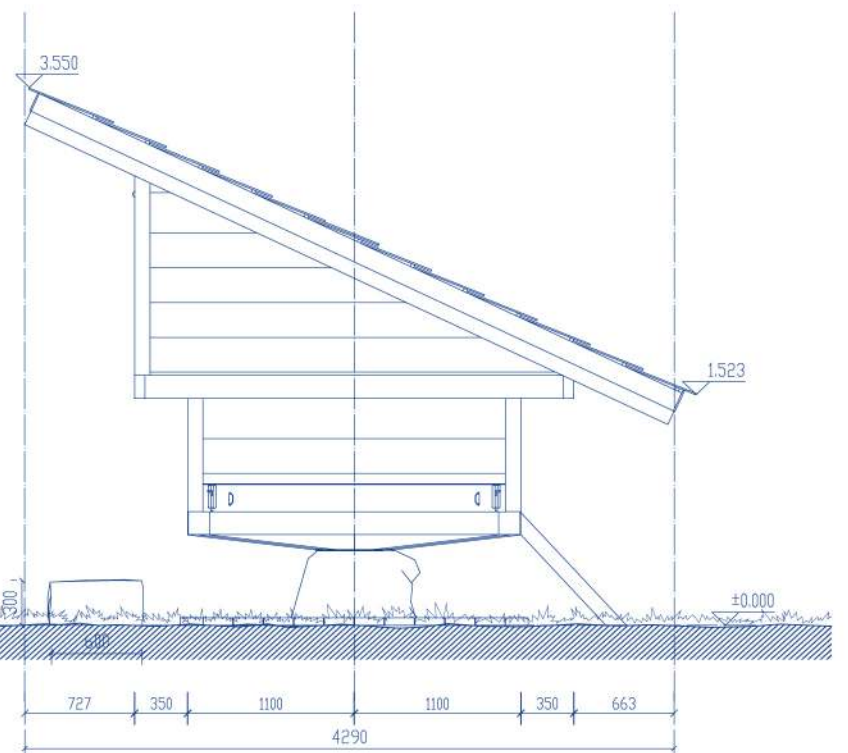

South & North Elevation 1:50

# Ten-feather Cottage

## Centralized Daily Work Area

Nearly all routine staff tasks are performed outside the coop, allowing the interior to be scaled exclusively to the chickens.

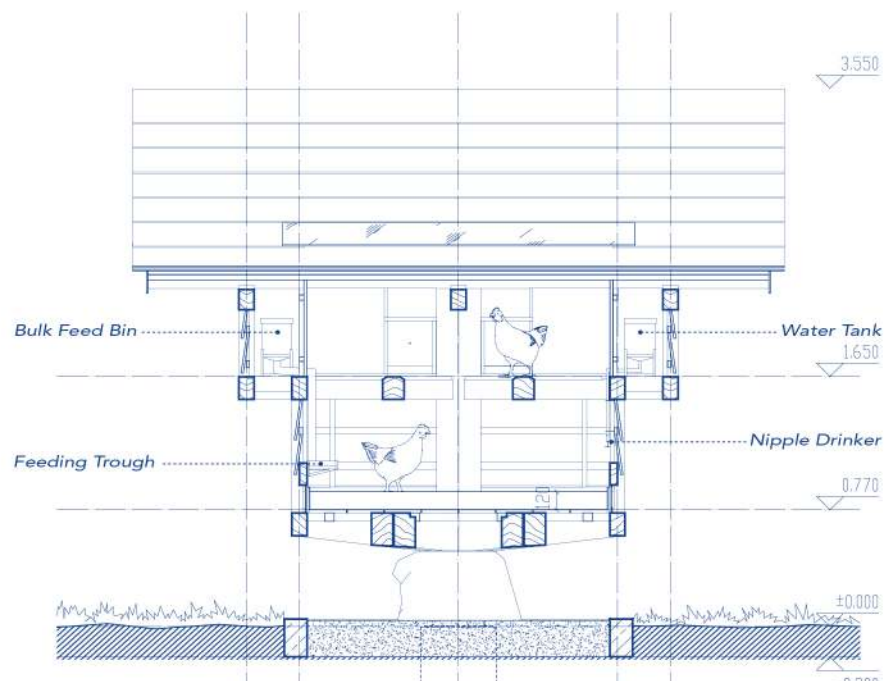
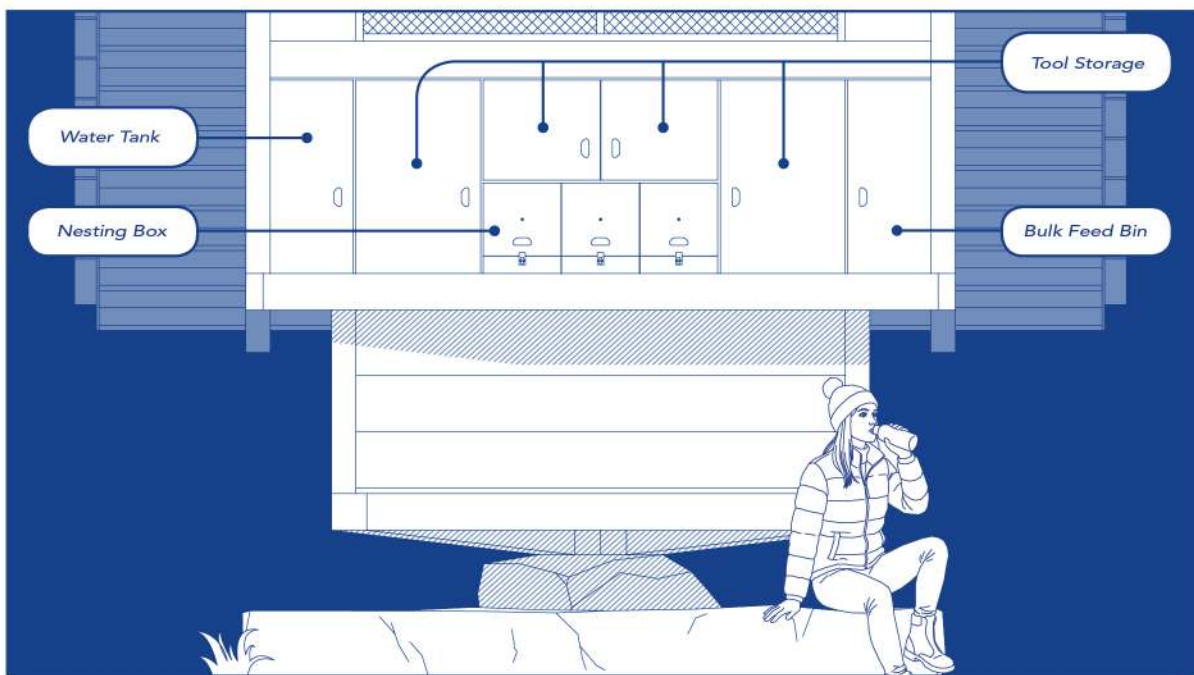

Section 2-2 1:50

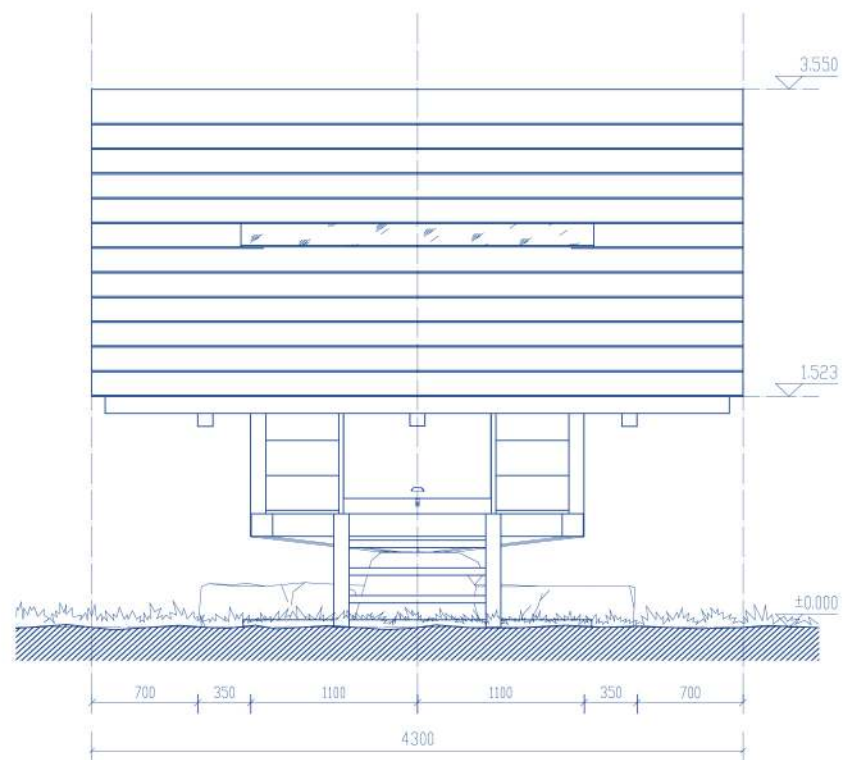
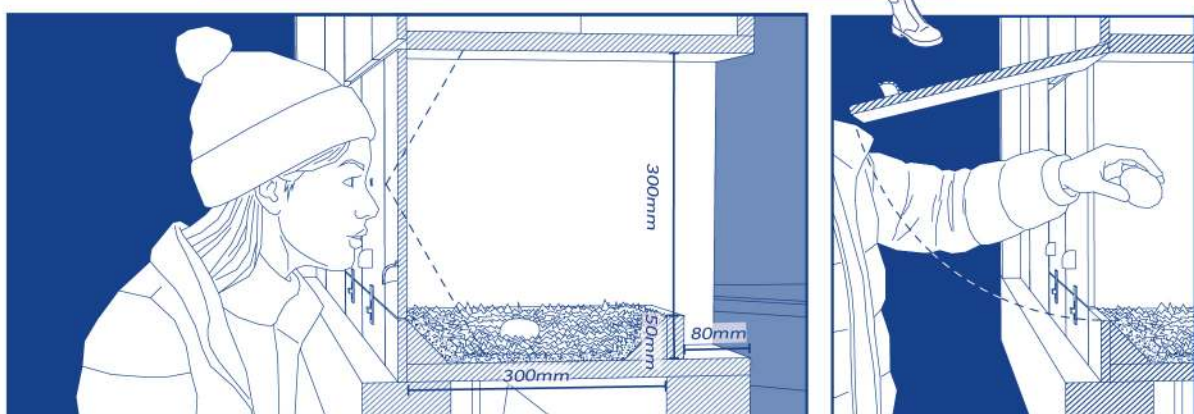

West Elevation 1:50

## Annual Deep Cleaning & Bedding Renewal

bedding tray features a pull-out design, allowing complete removal from the coop for thorough litter replacement and cleaning.

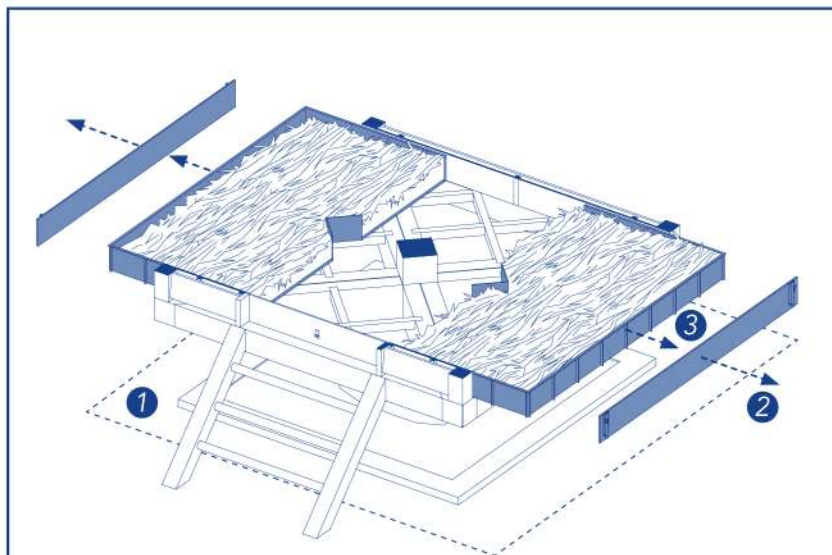

Preparations for the annual deep clean

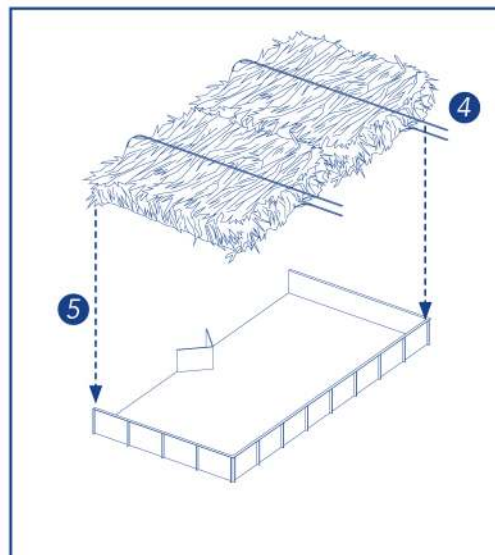

Bedding Renewal (After cleaning)

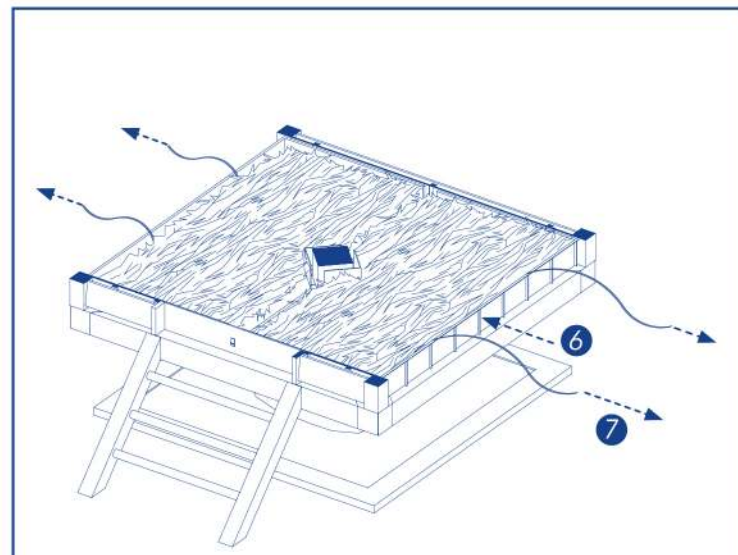

Reinstall the bedding tray.

1. Deploy tarpaulins to protect the site and sand bathing basin.
2. Remove timber side panels.
3. Slide bedding trays out along its limit-stop rails.
4. Lay tie-down straps on the bedding trays.
5. Place hay bedding at a right angle to the tie-down straps, then tighten tie-down straps.
6. Reinstall bedding trays.
7. Remove the tie-down straps and reinstall timber side panels.

# Ten-feather Cottage

