

The coop is located at the centre of the farmstead, close to the existing building on the western edge of the site. Rather than introducing a new foundation, the project builds upon what is already there: an existing stone wall serves as the primary base, complemented by stones found on site as point foundations. This approach minimises material use and ground intervention while continuing, rather than replacing, existing elements.

The form develops upward from a narrow footprint anchored to the wall, gradually expanding towards the roof. Timber cladding, a simple metal roof, and overlapping wooden boards allow the structure to blend naturally into its rural context. Its deliberately simple expression gives it a clear architectural presence while maintaining autonomy within the ensemble. The figure follows the programme directly: at wall level, the hens enter, leading to a protected retreat above. A functional intermediate layer accommodates nesting boxes, egg collection, and additional uses such as small tool storage or water collection, ensuring access for humans.

The construction is based on a clear and robust timber structure, designed for simple assembly and durability. Elevating the building protects it from ground moisture, while access from both front and back facilitates cleaning and maintenance. The modular structural grid can be extended beyond its current layout, allowing future adaptation.

The henhouse is conceived as a small yet precise piece of architecture shaped by site, programme, and construction logic.

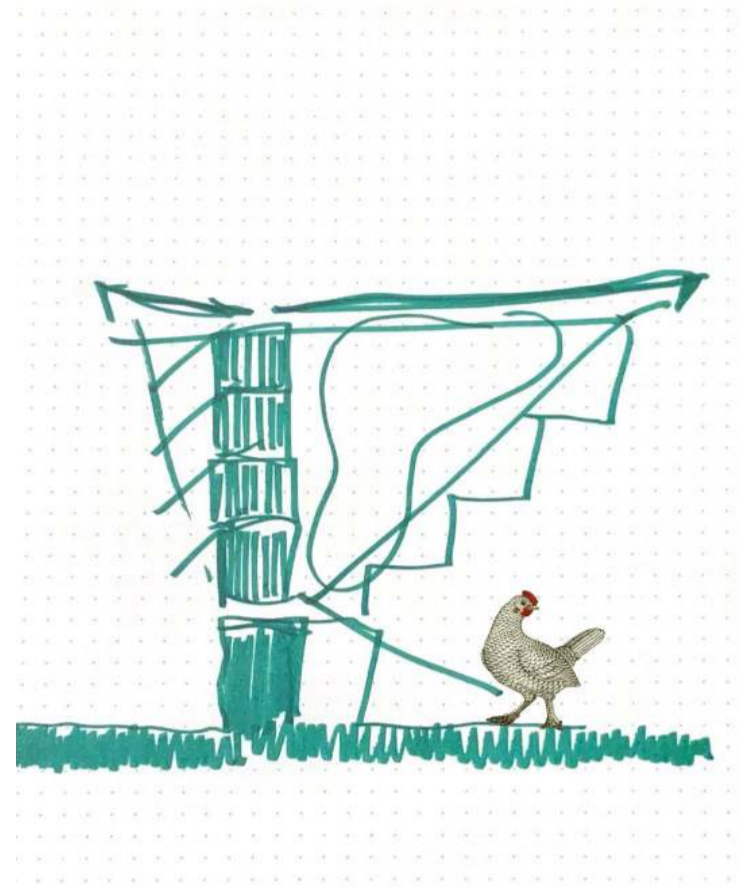

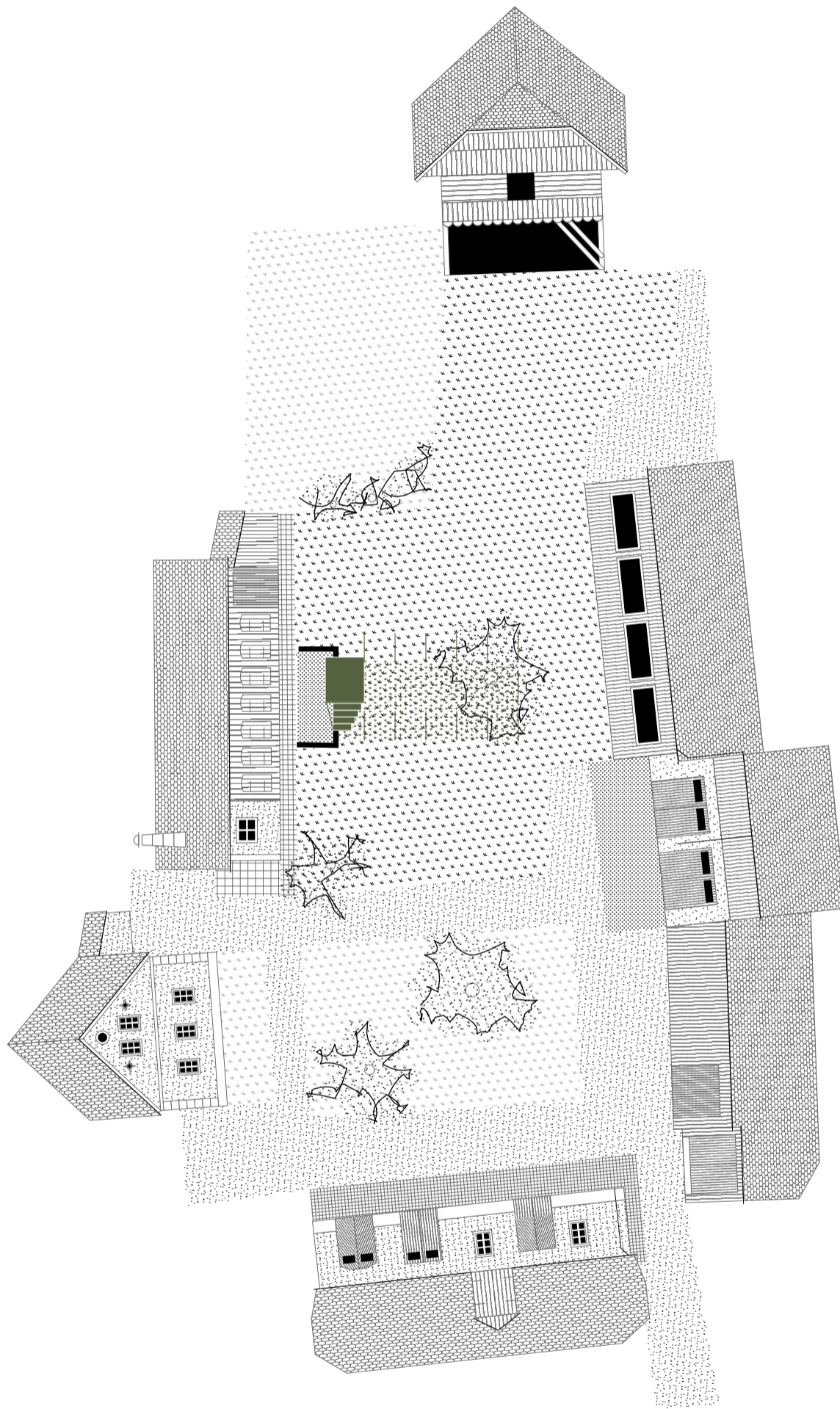

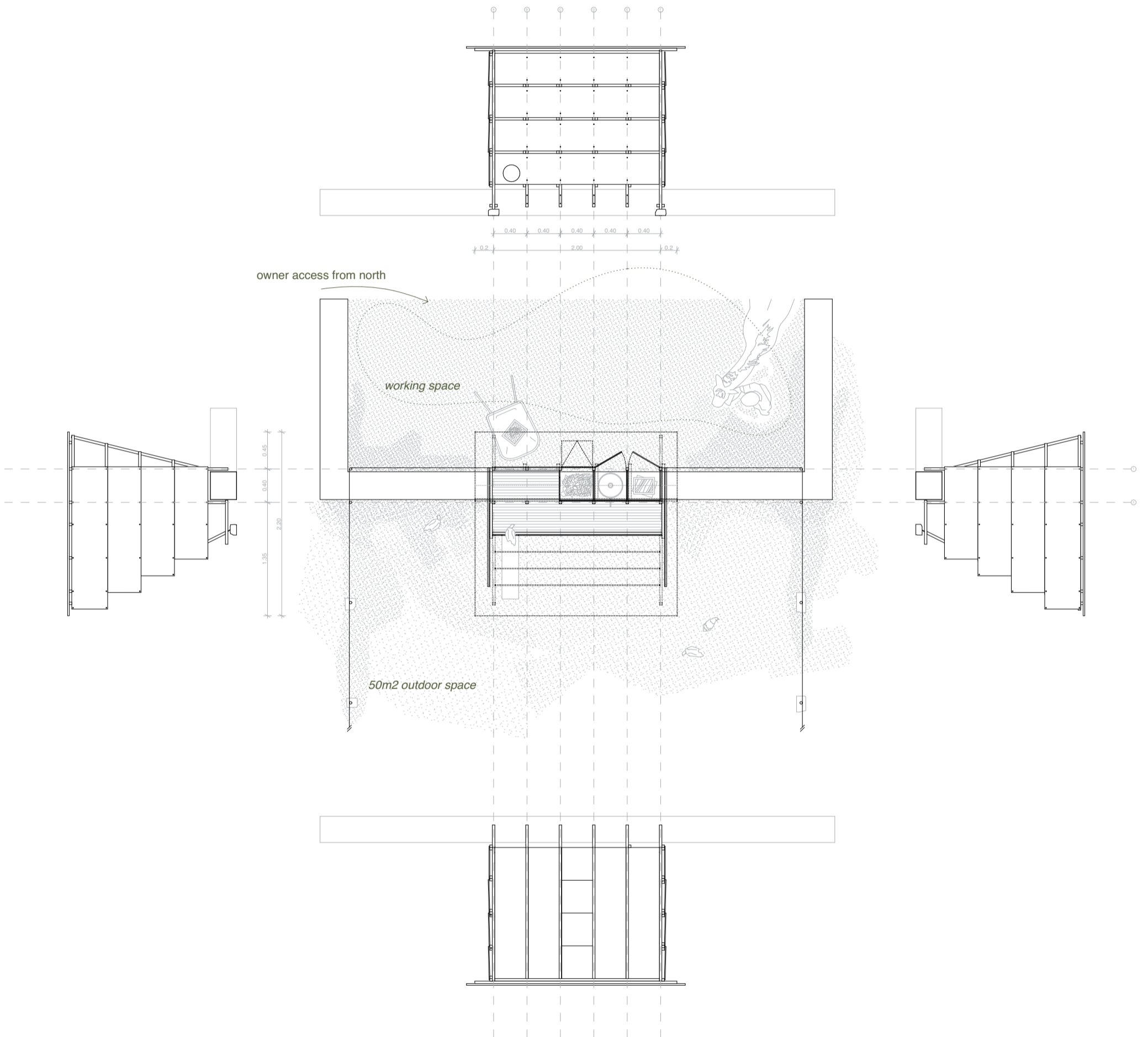

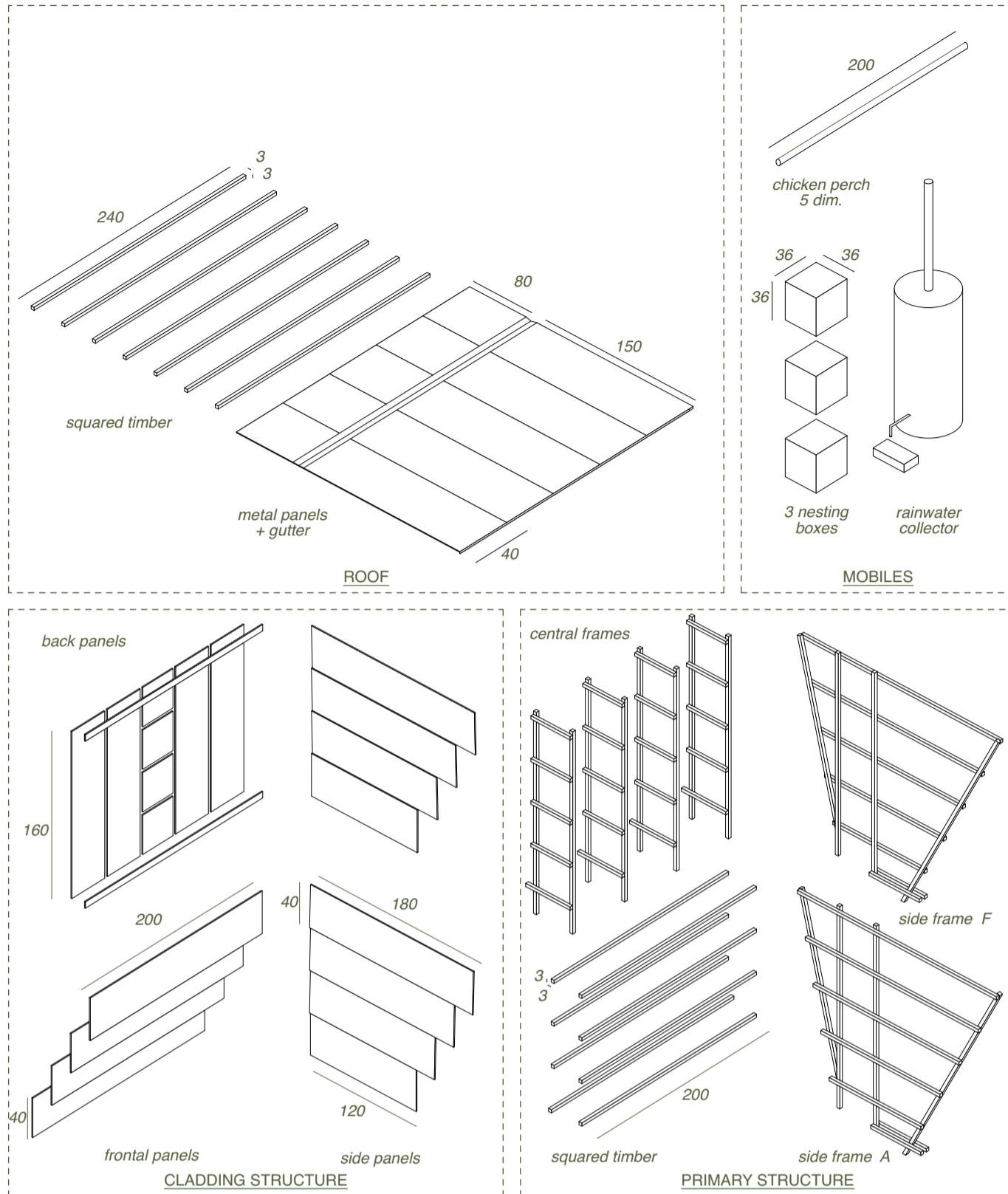

*dimensions in cm

