



The hens rummage freely while the association (and the dog) witnesses the experiment

FRANKIE

production rises
when hens are happy!

Concept

In *Swooner Crooner*, 1944, Porky Pig runs a (F)lockeed egg factory where Frankie the rooster — a parody of Frank Sinatra — sings and sends the hens into literal ecstasy, causing them to faint like fans at a concert and halting production.

Porky holds an audition: the winner is a rooster parodying Bing Crosby, whose more balanced crooning revives the hens and sparks a competition with Frankie, generating staggering output. In the end, when Porky asks the two for their secret, they simply sing — and he lays a mountain of eggs himself. Adult war irony with a serious message: the right environment and appropriate stimuli generate efficiency without coercion. **This project translates that metaphor into architecture.** No cages, no forcing: a henhouse that maximizes animal welfare as a functional strategy, where the hens' happiness is productivity. The competition brief calls for a dose of irony and sober conceptual thinking et *voilà*: Frankie, a stand out micro-building, easily constructible during a workshop, **recognizable as a small architectural object that dialogues with Slovenian agricultural tradition without imitating it.** This dialogue emerges through three territorial archetypes, recomposed into a contemporary geometrical figure.

THREE SLOVENIAN ARCHETYPES, ONE CONTEMPORARY FIGURE

Čebelnjak – the Slovenian beehive

Side panels that open like the extractable frames of local beekeeping: each nest box is inspectable from the outside with simple, orderly maintenance following rational daily cycles.

Kozolec – the haystack rack

Elevated volume: minimal ground contact, maximum ventilation. The shelter beneath the coop provides continuous shade and protection.

Košara – the ventilated container

Timber slats with uniform base width and variable heights (30–50–80 mm, Fibonacci sequence) applied to a structure. Not a weave, but it behaves like a košara: it filters air and light, protects, and in this case conceals openings. Result: a volume that hides functions within a simple form of elementary proportions.

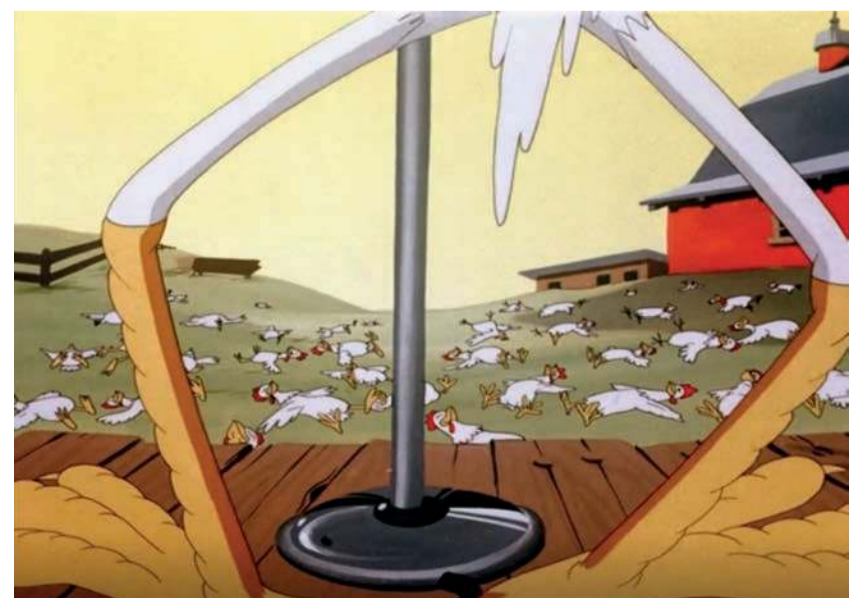

880468

The Happy Hen Manifesto

FRANKIE is a machine for happy hens.

It protects in winter, opens in summer.

Connects people to the daily rhythm of the farmstead.

Nothing more.
Nothing less.

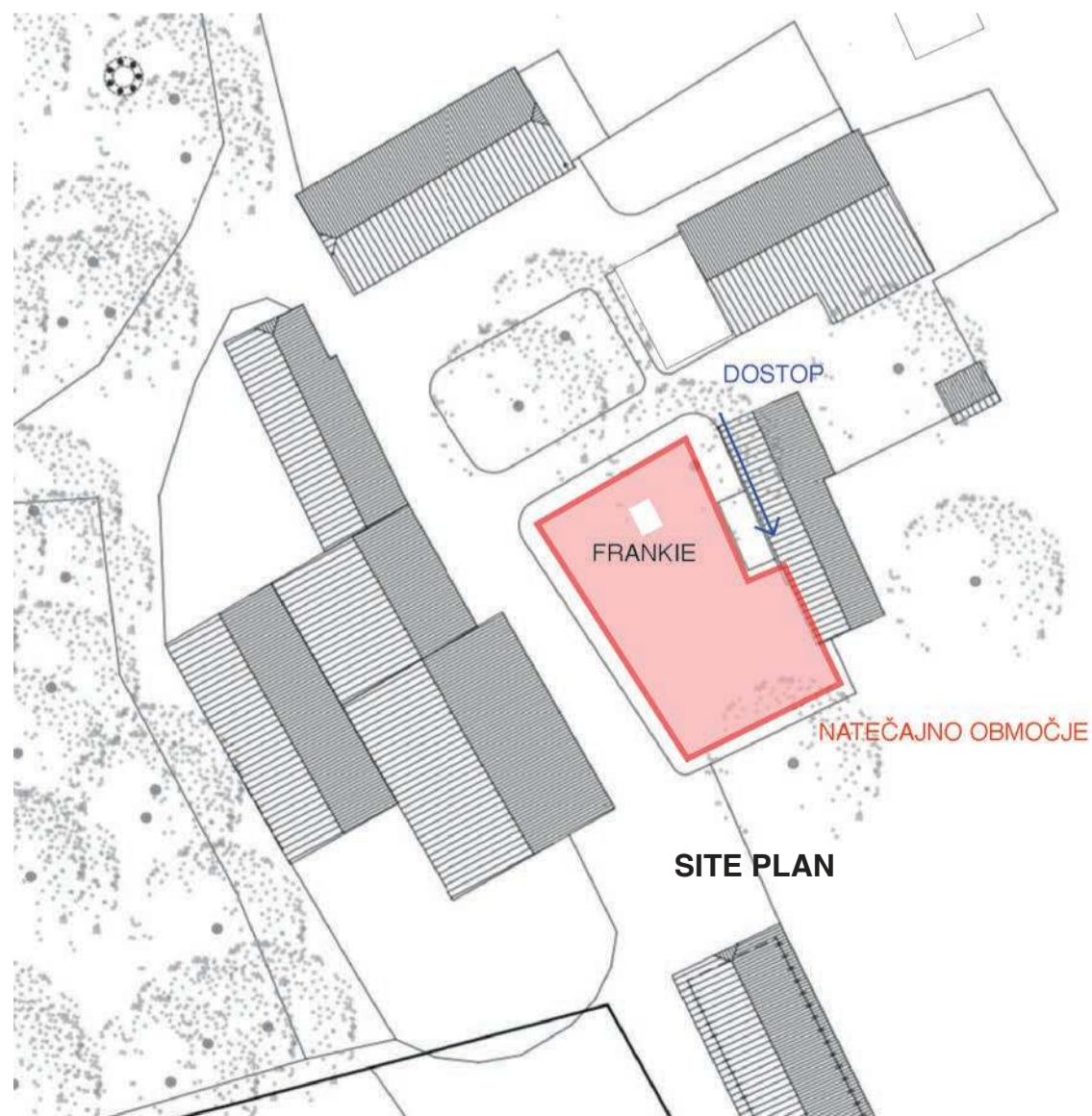
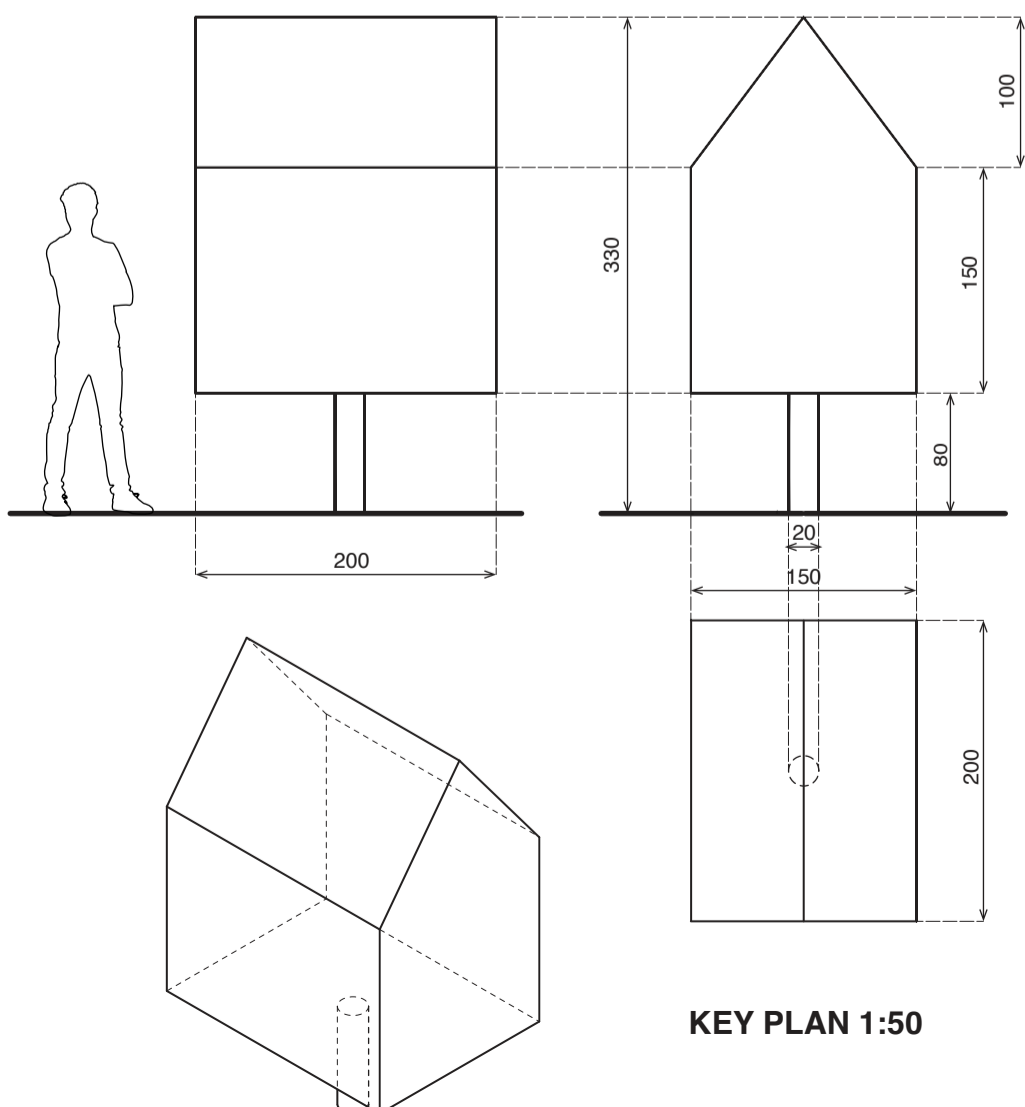

880468

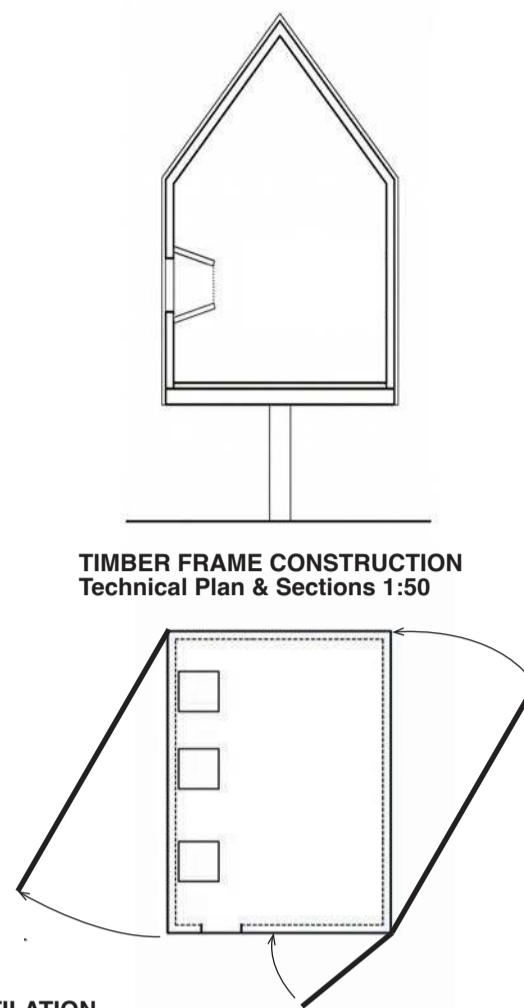

TIMBER FRAME CONSTRUCTION
Technical Plan & Sections 1:50

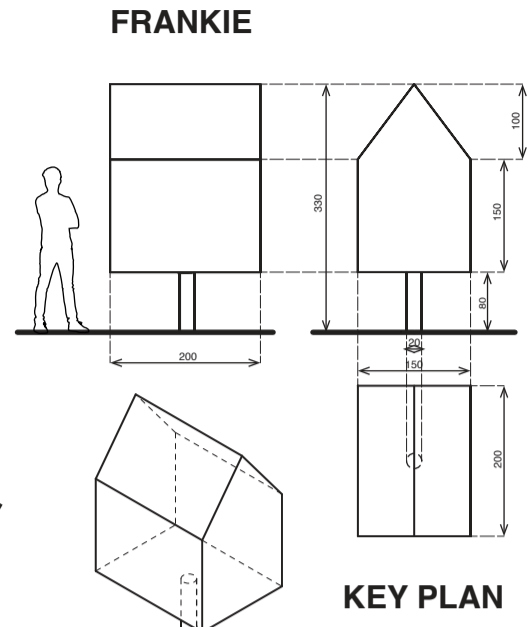

FRANKIE

KEY PLAN

TIMBER FRAME

Locally sourced Larch structure. Naturally durable cladding. Breathable eco-friendly insulation. Low carbon footprint impact.

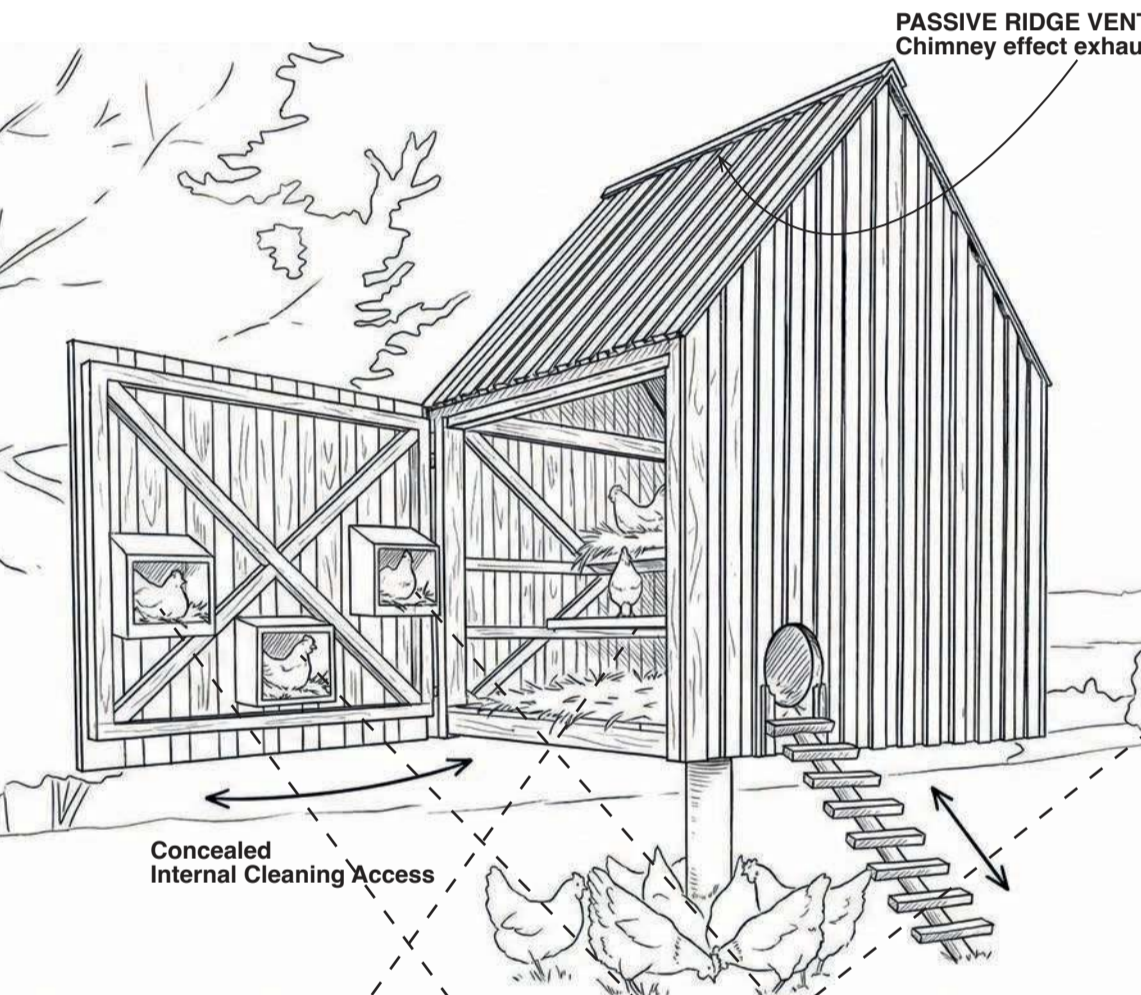

Perches: 2 x 110 cm = 220 cm total.
Spacing 35 cm. Height 60 cm.

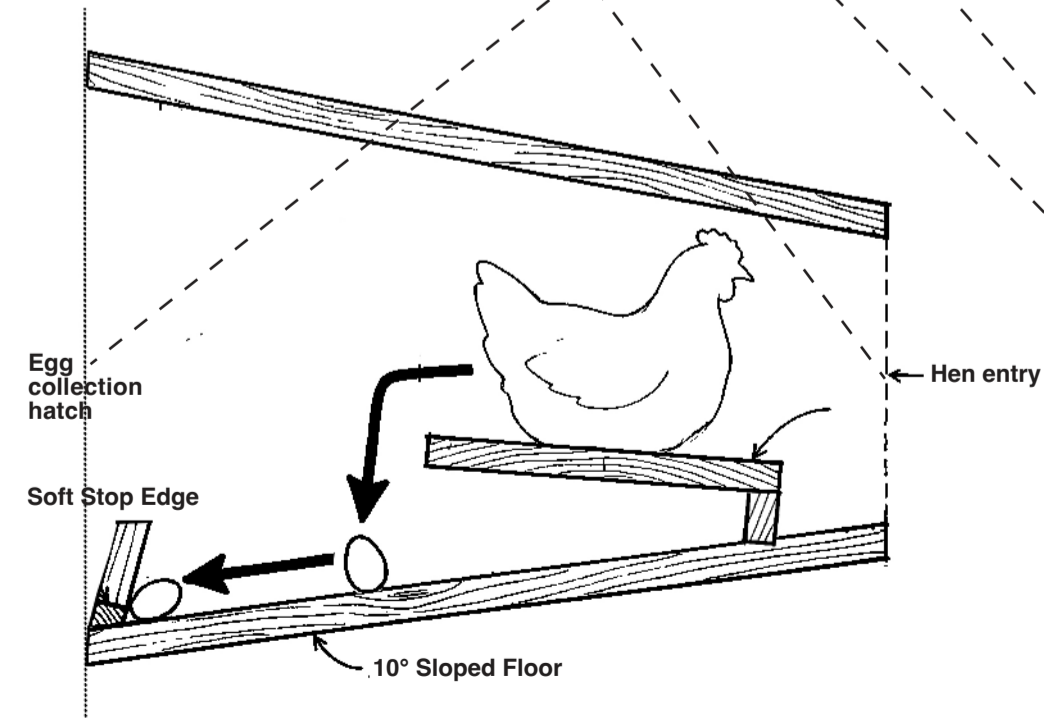
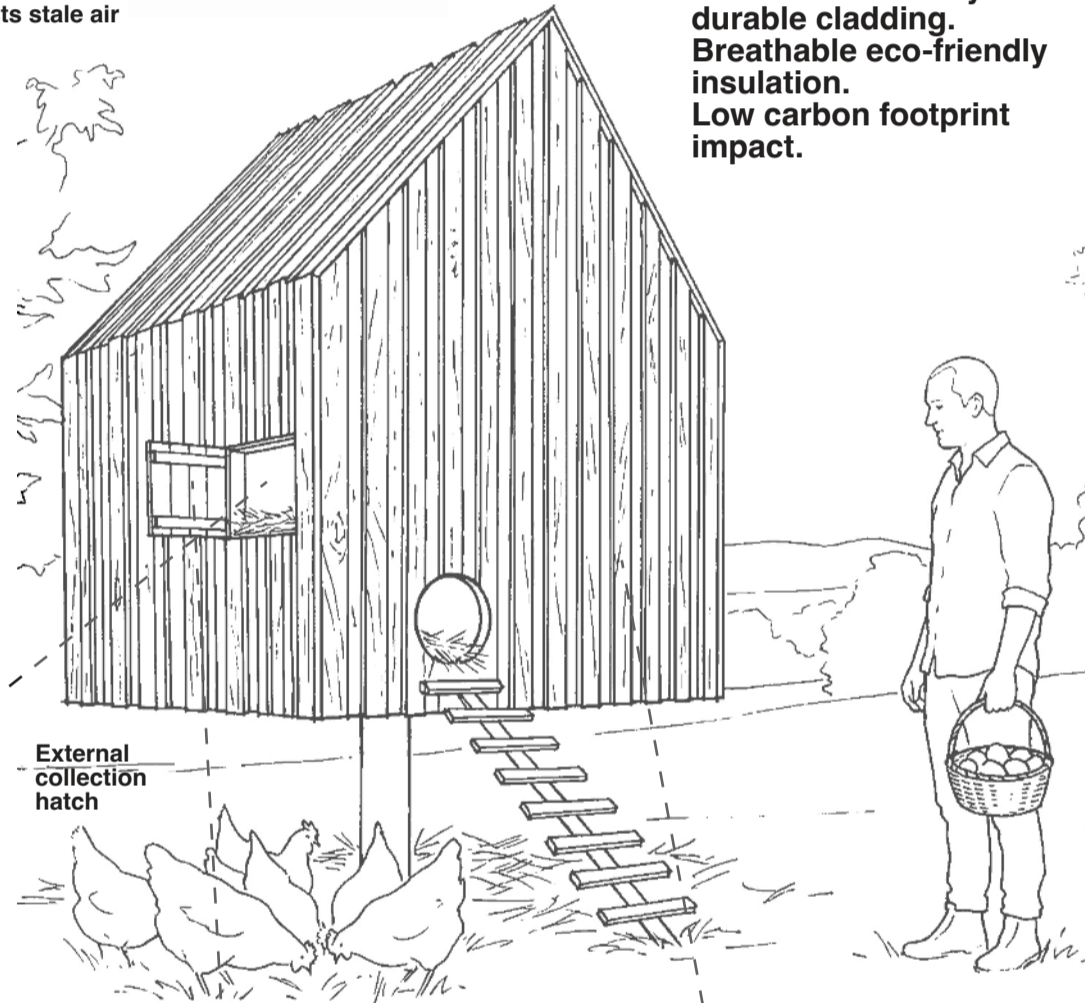

WOODEN NEST BOX
ROLL-AWAY NEST SYSTEM
Gravity-fed egg collection mechanism

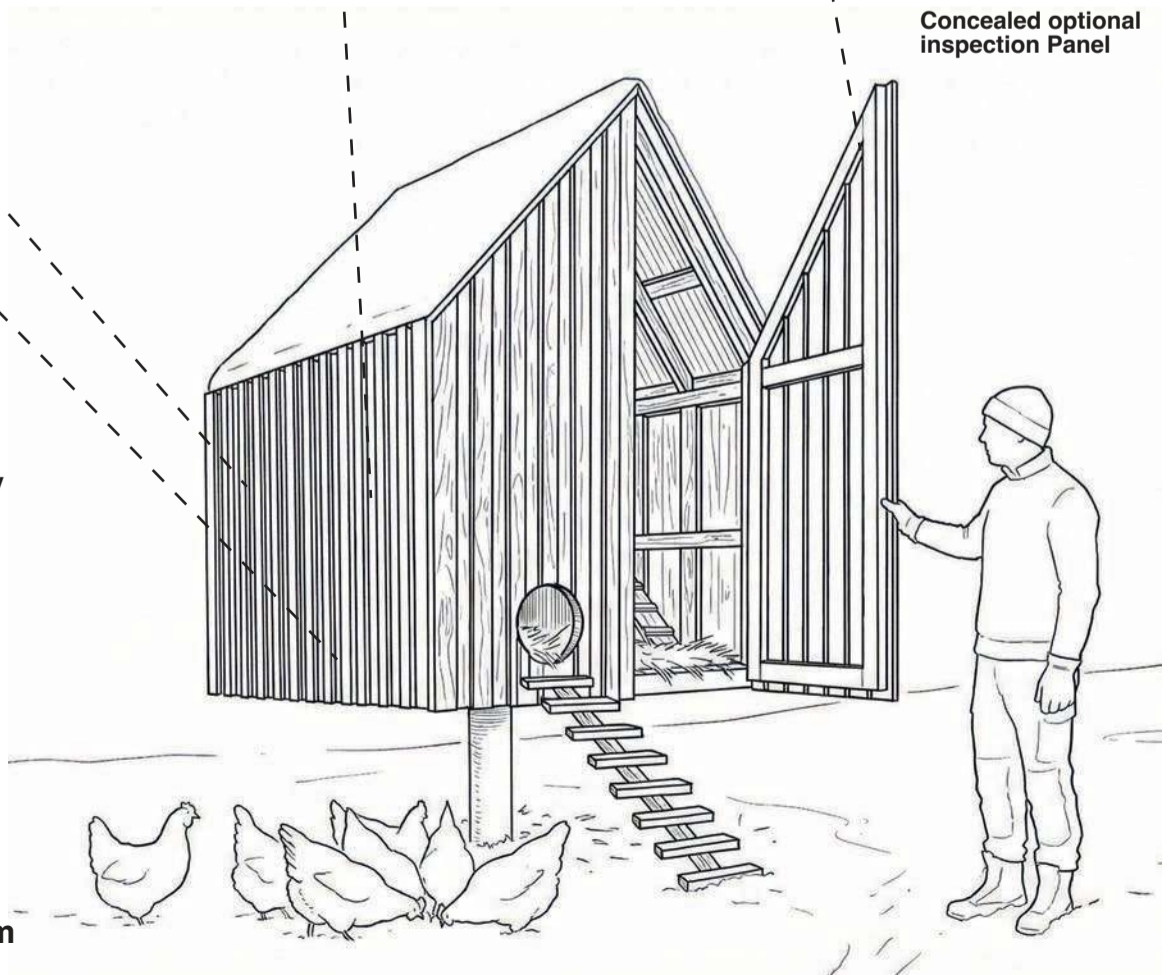

ALTERNATIVE STEEL SKELETON

Primary option: timber frame (Sheet 3)
 Steel alternative: prefabricated, rapid assembly, fully recyclable
 Minimal footprint — Kozolec principle.
PRIMARY SKELETON
 Galvanized Steel Frame
 SHS 40x40x3 / RHS 40x30x3

SECONDARY SUPPORT
 Cladding Sub-structure
 Flat bar purlins 30x4 mm

880468

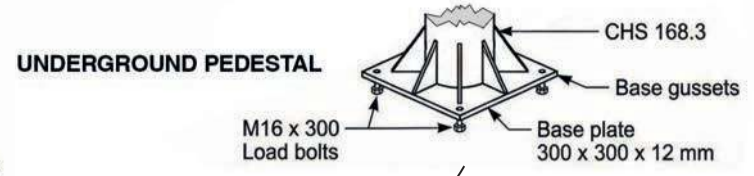
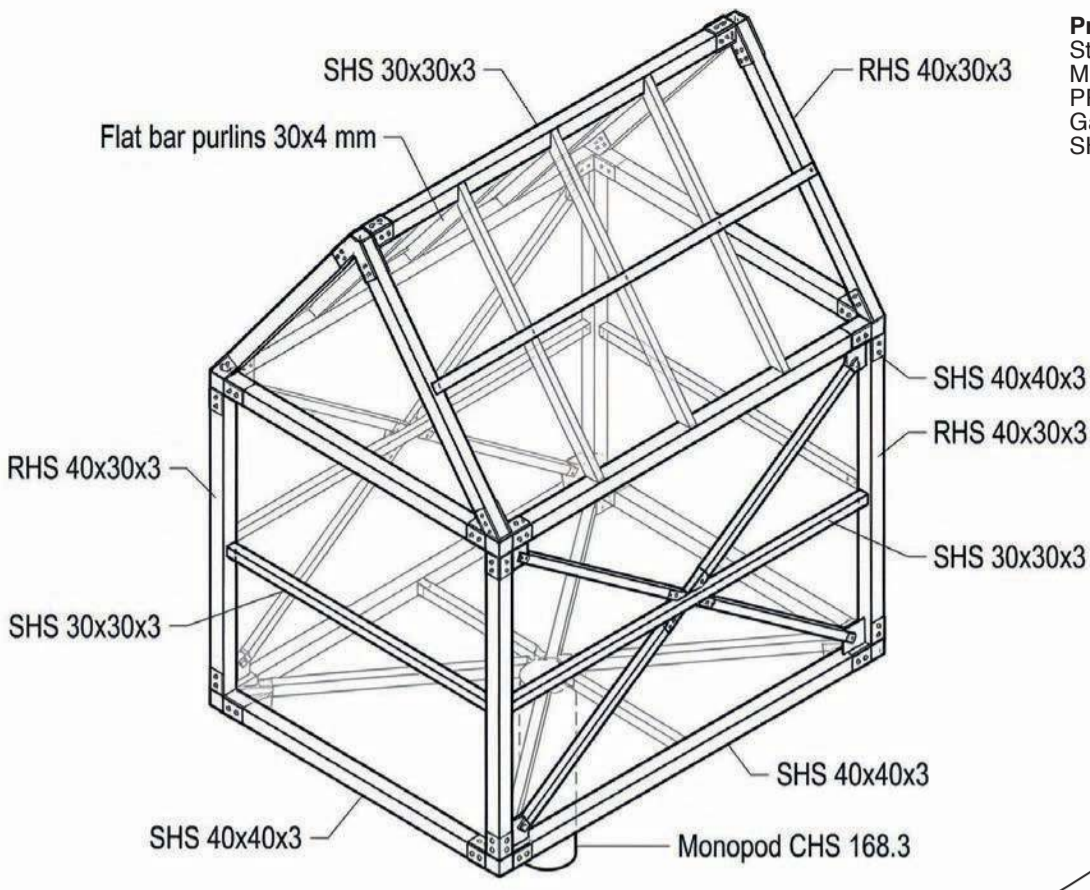

REVERSIBLE FOUNDATION

FRANKIE

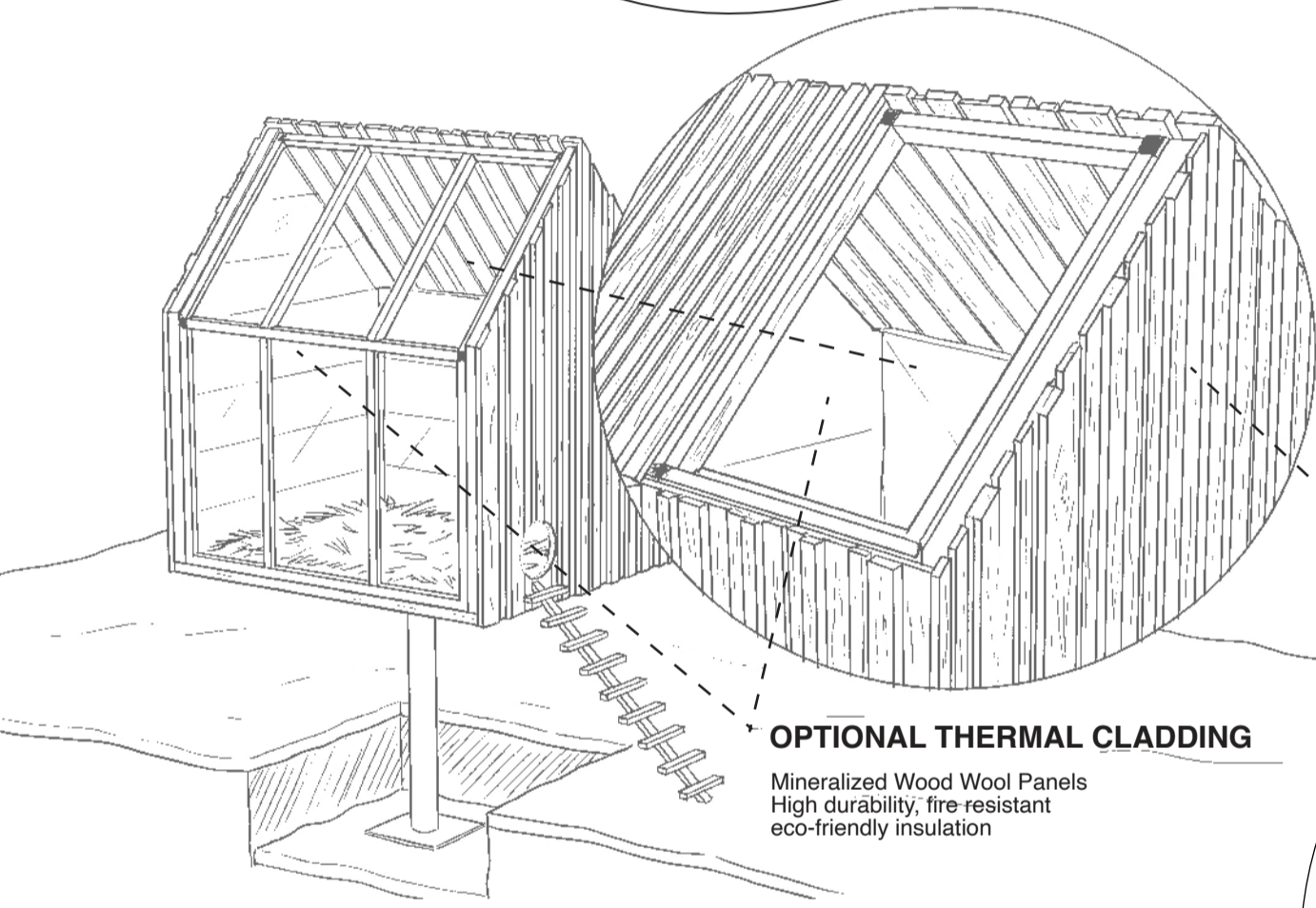
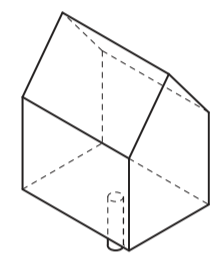
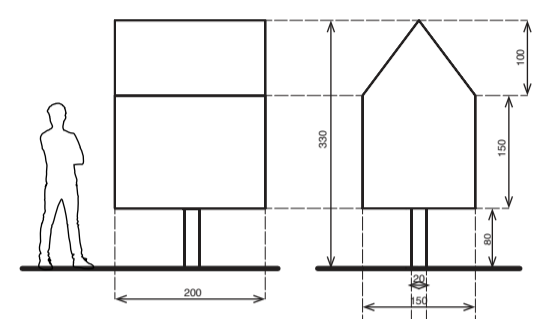

FIBONACCI PATTERNED WOOD SLATS

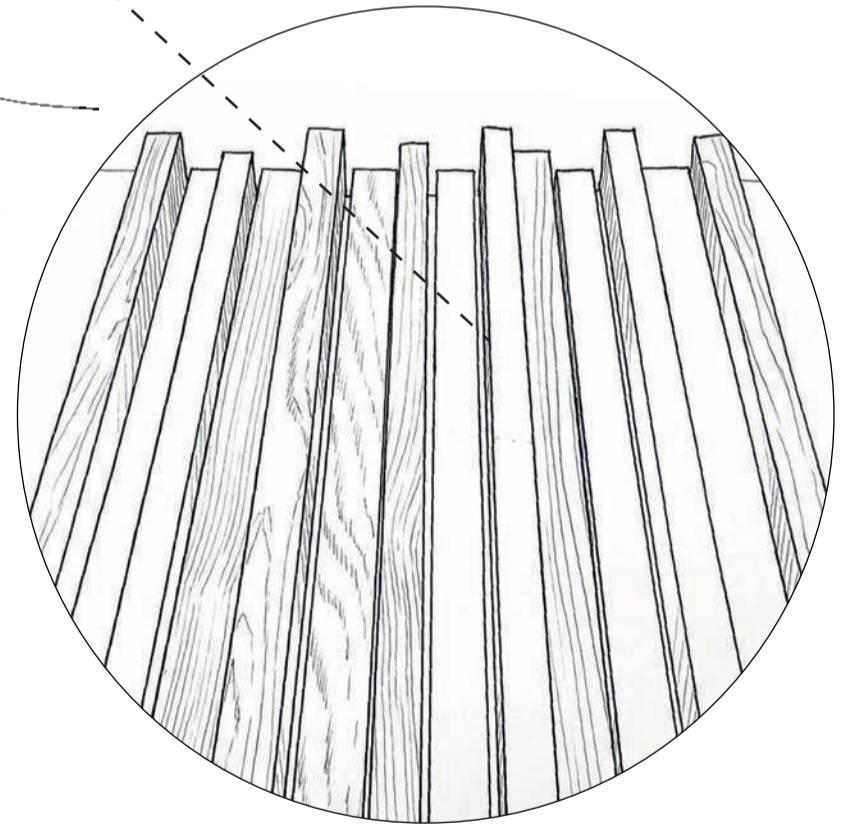

SMART CLOSURE SECURITY MECHANISM

Motorized Rotating Shutter, manually operable in case of power failure.
 Direct-drive coaxial motor on pivot. Clockwise opening action.
 Light sensor activation (Dawn/Dusk). Battery-powered.
 Low-cost, low-maintenance.

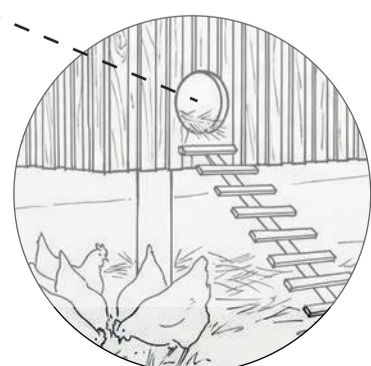
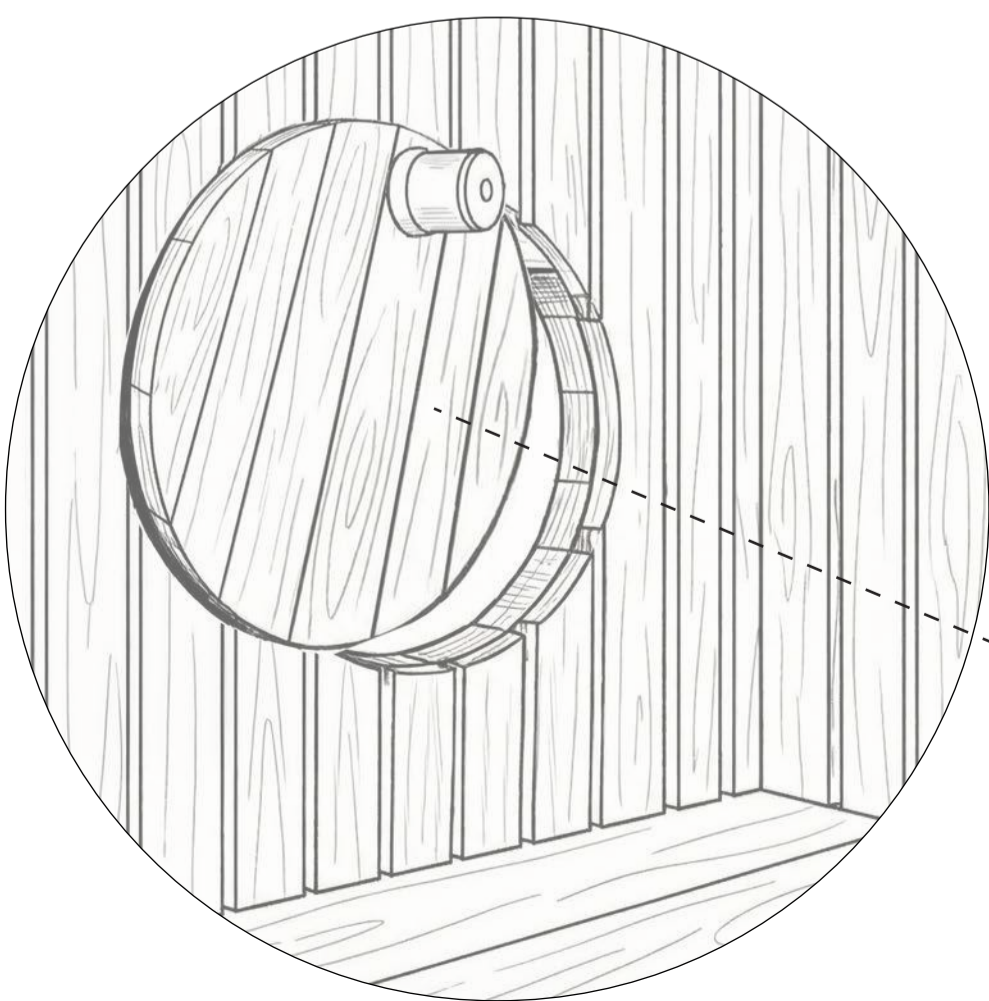

ASSEMBLY & MAINTENANCE

Build sequence: foundation → wood (or steel) frame
 → substructure → wood slats → nest boxes & perches
 → shutter system → thermal cladding (optional).
 Daily egg collection. Weekly litter removal.
 Annual slat treatment and battery/sensor check..

OPTIONAL WIRE SUNDIAL (LOCAL DATA)

Dobrava pri Škocjanu
Latitude 45:52:32 N
Longitude 15:19:36 E

Coop wall declination angle 12 E



FRANKIE

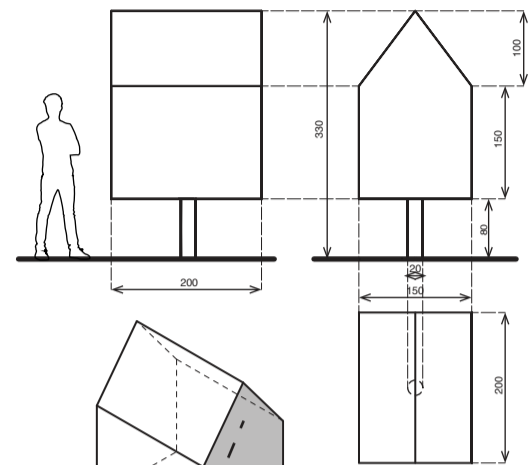

KEY PLAN

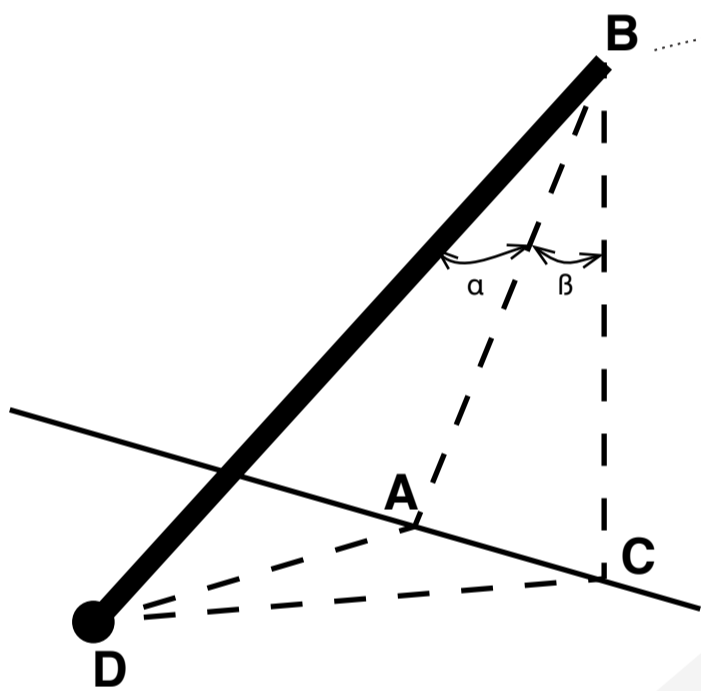

STYLE (GNOMON) DESIGN DATA

Ortostyle AD	20 cm
Polar Style BD	29.37 cm
Substyle angle β	11.4 deg
Substyle angle α	42.92 deg
Substyle AB	21.31 cm
A	(0.0; 0.0)
B	(4.25; -21.08)

SUNDIAL MOTTO

Frankie sings
time flies
eggs remain

DIAL FACE ELEVATION

current extent: about 120 x 120 cm (H x W)

Caveat
SITE-SPECIFIC CALIBRATION REQUIRED
Geographic coordinates, façade orientation and time convention **must** be accurately surveyed and verified on-site before construction.

The dial face as drawn shows True Solar Time at the installation longitude. If Central European Time (GMT+1) or Daylight Saving Time (DST) is preferred, the hour lines must be offset accordingly. Geographic coordinates and façade orientation **must** be reconciled with the Equation of Time. The time you read depends on the time you choose to tell. Site longitude 15°19'E \approx Central Meridian GMT+1 rmeans longitude correction negligible.

**FRANKIE CANIT
TEMPUS FUGIT
OVA MANENT**

